

Area Light Direct Fixed Mount (ALADFM)

Installation Instructions

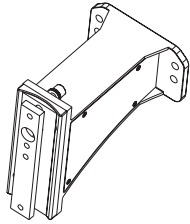

SAFETY INSTRUCTIONS AND WARNINGS

- When using electrical equipment, basic safety precautions should always be observed.
- This product must be installed in accordance with the applicable installation code by a person familiar with the construction and operation of the product and the hazards involved.
- Installation should only be conducted by a qualified electrician in accordance with NEC and any relevant local building codes.
- Be certain electrical power is OFF before and during installation and maintenance.
- To prevent wiring damage or abrasion, do not expose wiring to edges of sheet metal or sharp objects.

WHAT COMES IN THE BOX

Direct Fixed Mount
M8 * 25mm (x4)
Spring Washer (x4)
Flat Washer (x4)
Ground Washer (x1)
Installation Instructions

REQUIRED TOOLS

Allen Wrench

INSTRUCTIONS

*Before Installation, carefully remove all parts from the packaging. Inspect product for defects due to shipping.
Always turn off the power supply from main circuit breaker first!*

DIRECT FIXED MOUNT INSTALLATION

1. Open the side lid by removing the four screws. (Figure 1)

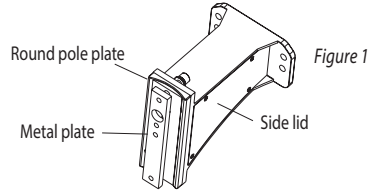

2. Pass the wires through the direct fixed mount (watch out not to scratch the wire).
3. Lock the direct fix mount on the fixture. (Figure 2)

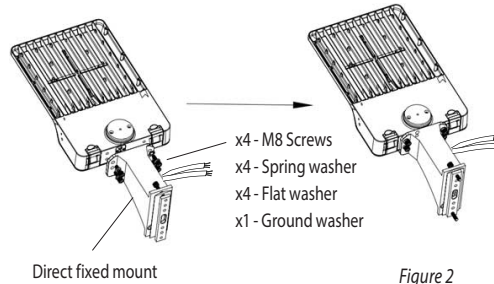

DIRECT FIXED MOUNT SQUARE POLE INSTALLATION

1. Unscrew and remove round pole plate and round silicon gasket from the back of the mount. (Figure 4)
2. Affix the direct fixed mount to the square pole, pull the wire from pole into junction box, and connect the wires accordingly (refer to area light installation instructions for wiring diagram). (Figure 5)
3. Use four screws to close side lid back in place.
4. Installation complete. (Figure 6)
5. Turn power back on.

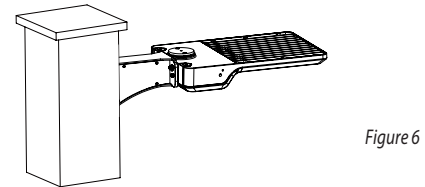
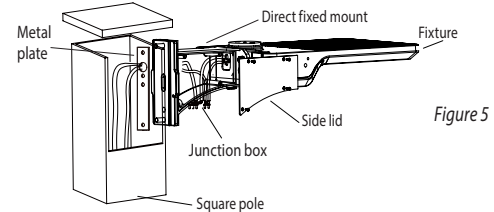
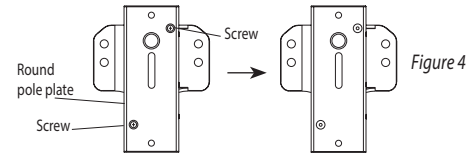

DIRECT FIXED MOUNT ROUND POLE INSTALLATION

1. For round pole installation, leave round pole plate and gasket installed and follow the previous steps for wiring directions. (Figure 7)

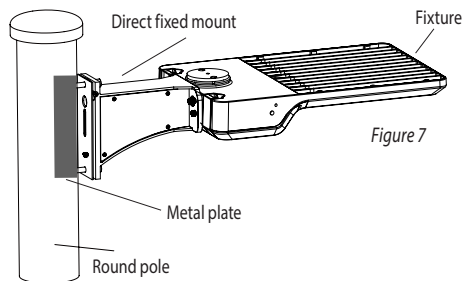
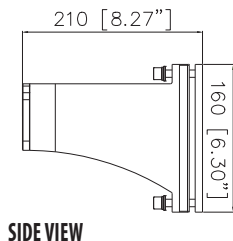

Figure 7

ALADFM - 150W ,200W 300W Hole Pattern

Note: All measurements in millimeters and inches.



SIDE VIEW

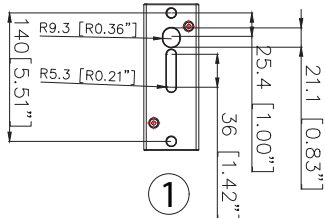

1
ROUND POLE PLATE

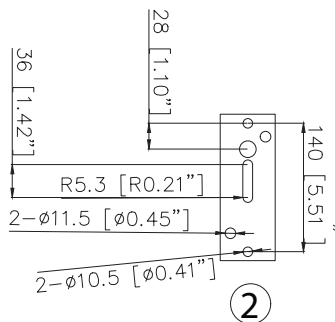

2
SILICON GASKET

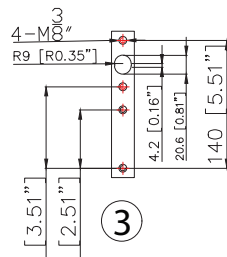

3
METAL PLATE

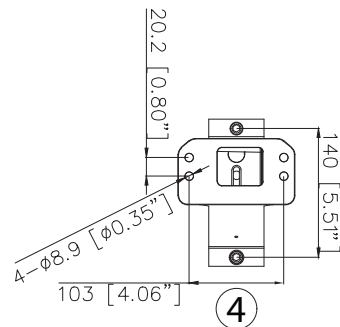

4
FRONT VIEW

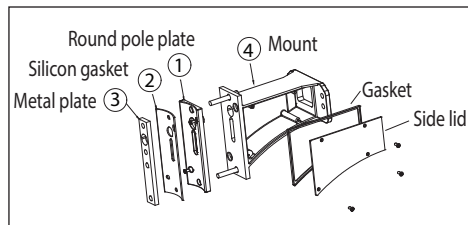

Thank you for choosing

LITETRONICS®

6969 W. 73rd Street
Bedford Park, IL 60638

WWW.LITETRONICS.COM

CustomerService@Litetronics.com or 1-800-860-3392



The information and product specifications contained in these instructions are based upon data believed to be accurate at the time of printing. This information is subject to change without notice and without incurring liability. If you have questions regarding specific product details, please contact us at 800-860-3392 or via email at customerservice@litetronics.com. To check for an updated version of these instructions, please visit www.litetronics.com.