

# LITETRONICS®

## Safety Cable Kit (HBAM30)

### Installation Instructions

To be used with full installation instructions for 16" LED Round High Bay Fixtures.

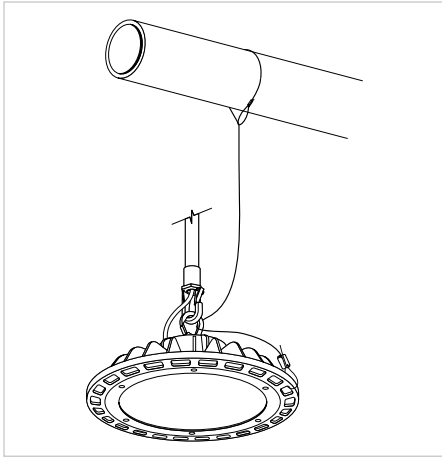

### WHAT COMES IN THE HBAM30 PACKAGE

Each Round High Bay Fixture Safety Cable kit comes with the following standard parts:



Before Installation, carefully remove all parts from the packaging.  
Inspect product for defects due to shipping.

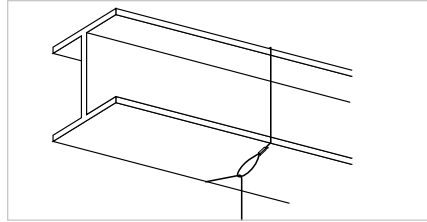

1. Determine area/structure to hang fixture from and attach cable to structure. Loop cable around beam, or other secure fixture.

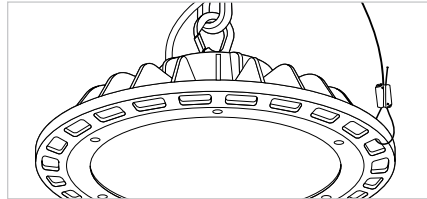

2. To attach cable to fixture. Attach safety cable directly to the frame of the High Bay and directly to the structure.

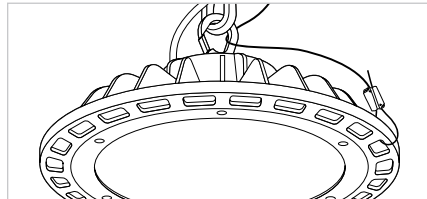

3. You can also route the cable from the frame through the snap hook of High Bay to minimize visibility from below.

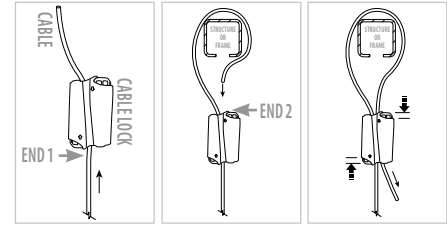

4. Run cable through End 1 of cable lock. Loop cable around structure. Then feed back into End 2. Tug cable to test/ensure security. Do this for all cables.

*Note: Compress cable lock ends to release cables.*